

WCD - Woolwich Creative District

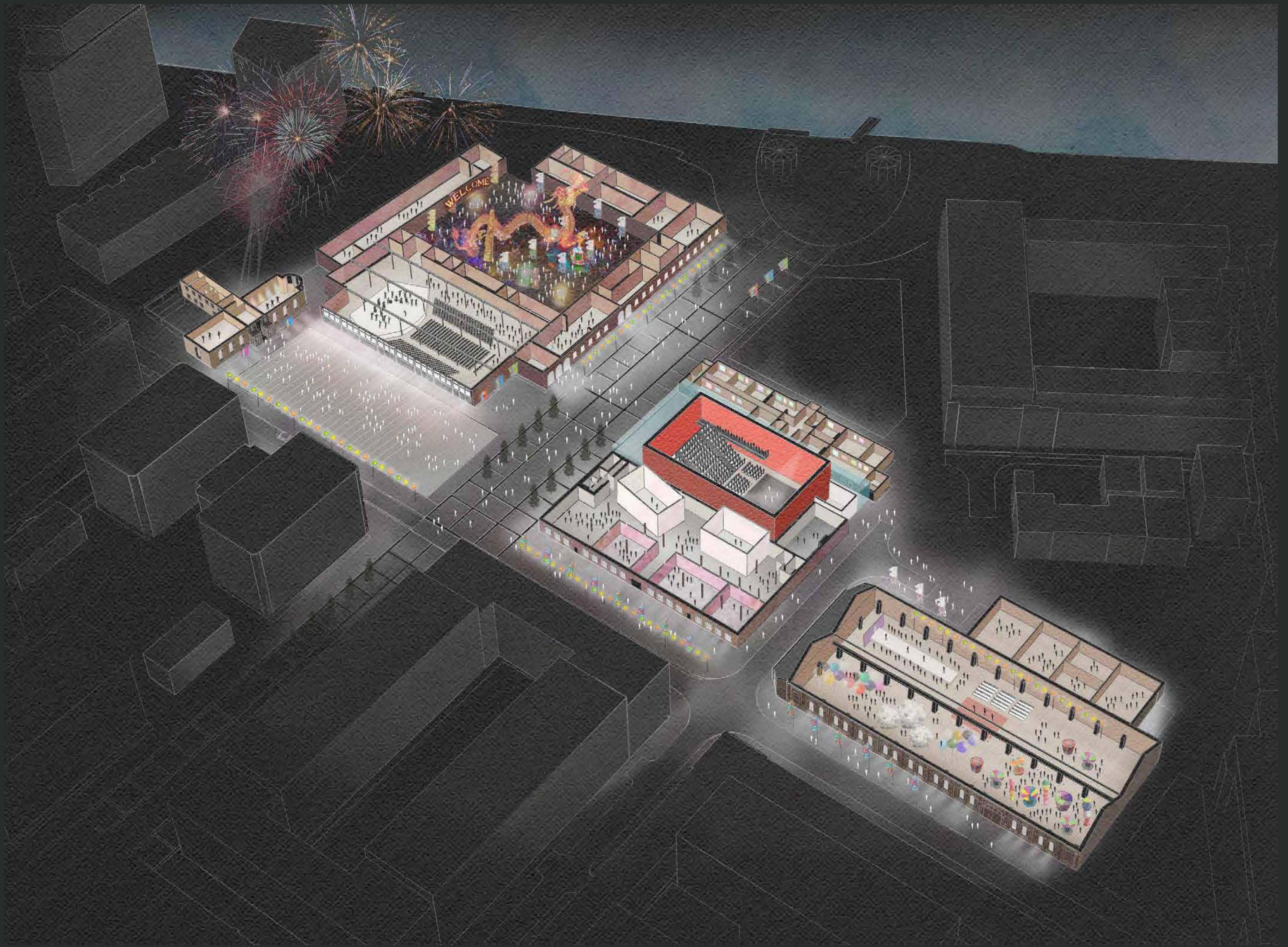

Creation of a new creative district at the Royal Arsenal, Woolwich

- Accommodating a range of key stakeholders from performing arts to heritage organisations, both from the local area and outside the borough, that will attract national and international audiences
- Adaptive reuse of four Grade II and one Grade II* listed buildings within the Royal Arsenal Conservation Area, providing over 15 000m² of flexible space
- Opportunities for public interaction and involvement, training and education for both local residents and visitors and new jobs
- Celebrating the history of the Arsenal through reuse of its buildings and streets - allowing the historic presence of the Army in Woolwich to do what the Navy did for Greenwich

Woolwich Creative District

Visuals

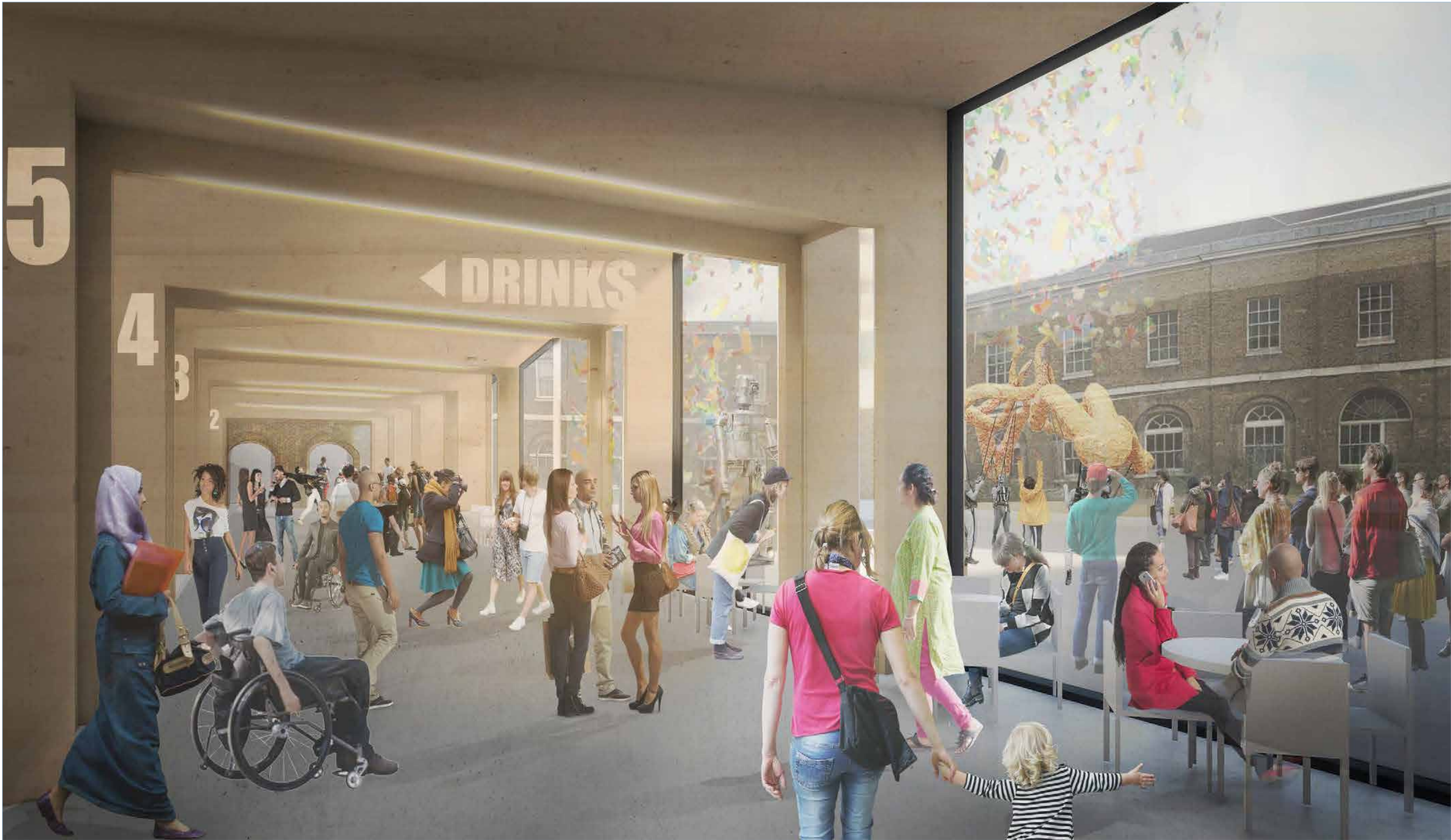
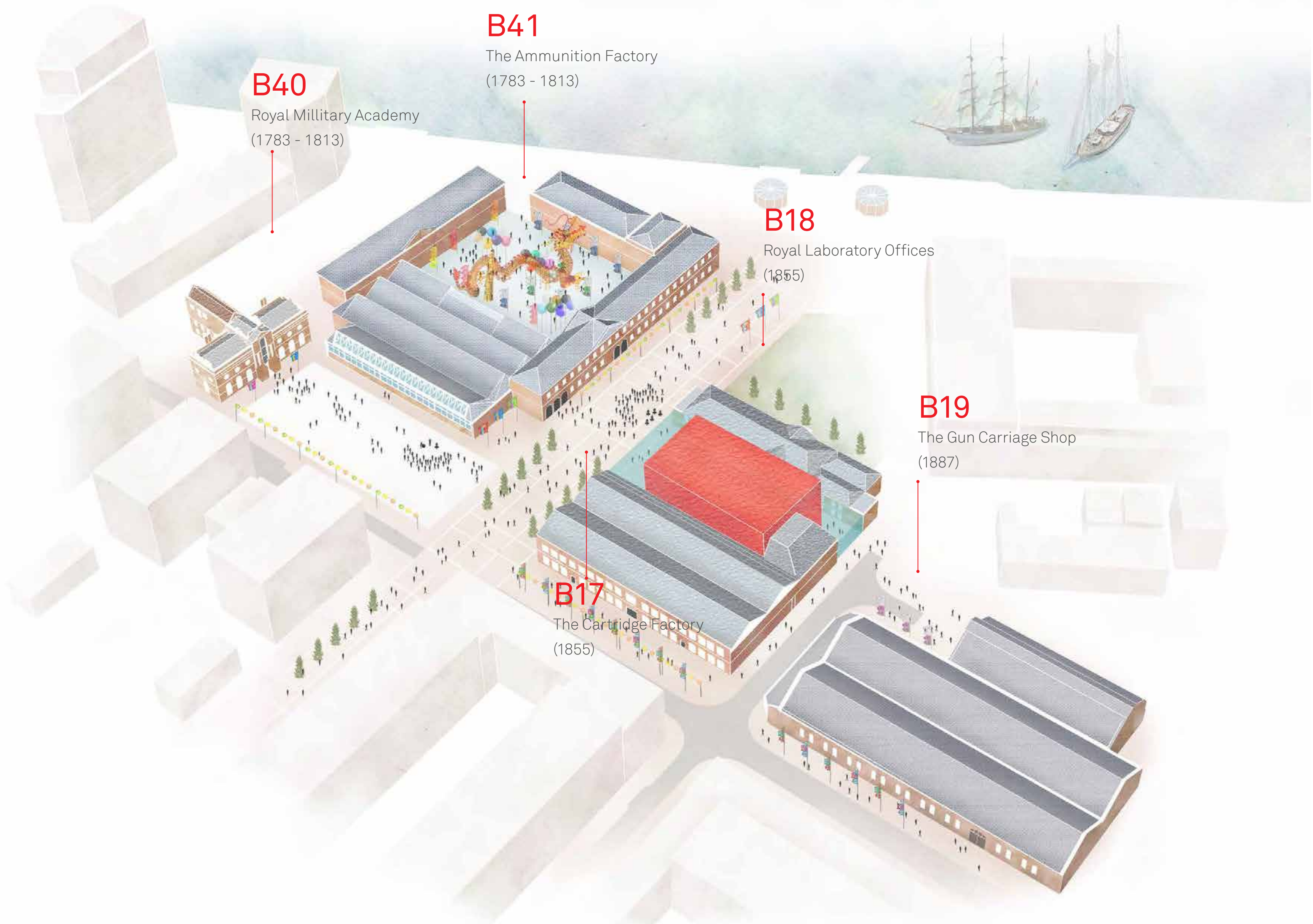

Woolwich Creative District

Visuals



Woolwich Creative District

Visuals



Woolwich Creative District Site Overview

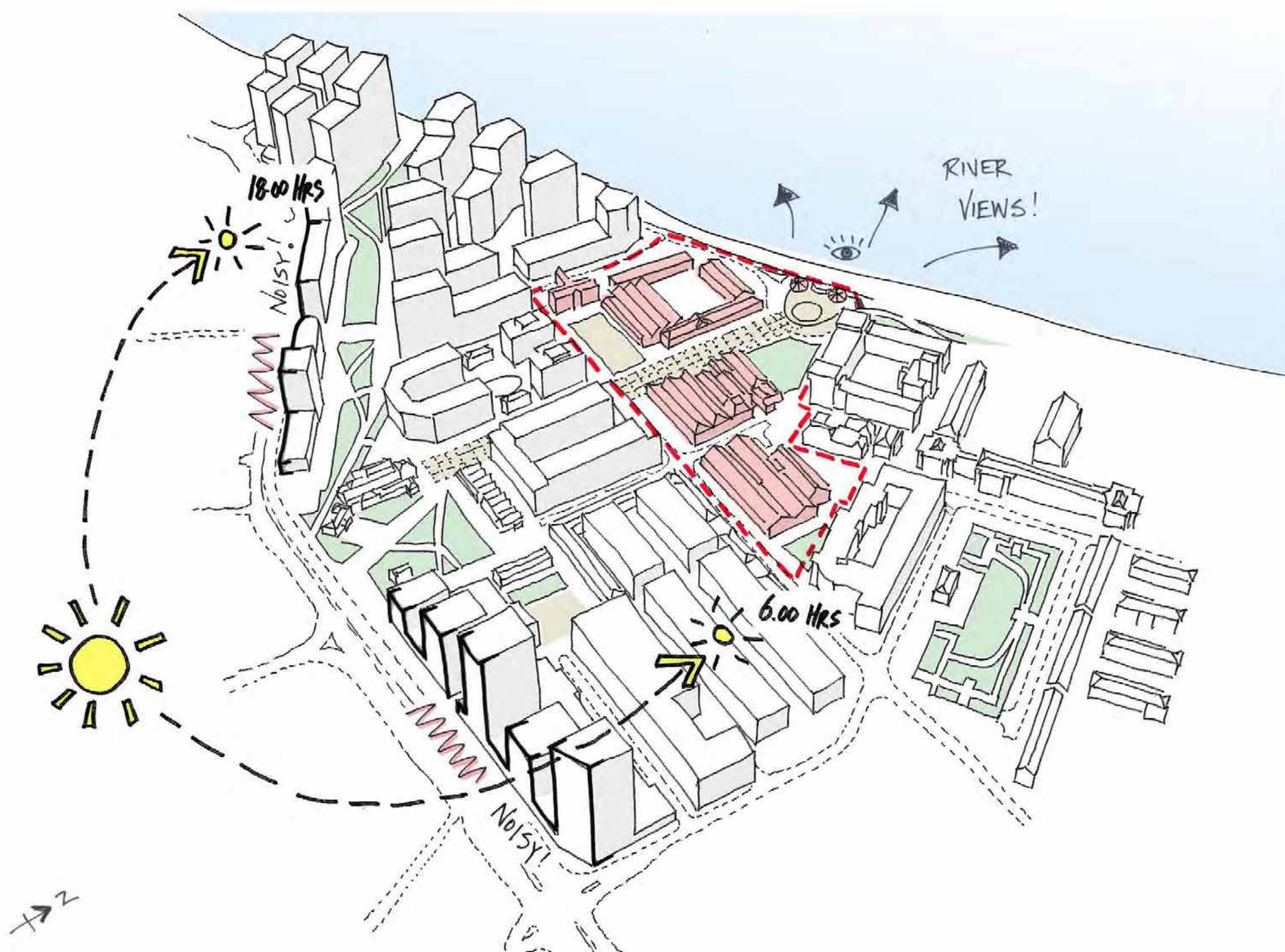

Climate

The site has a great deal of potential with outstanding views looking over the River Thames and a north/south orientation offering good natural daylight.

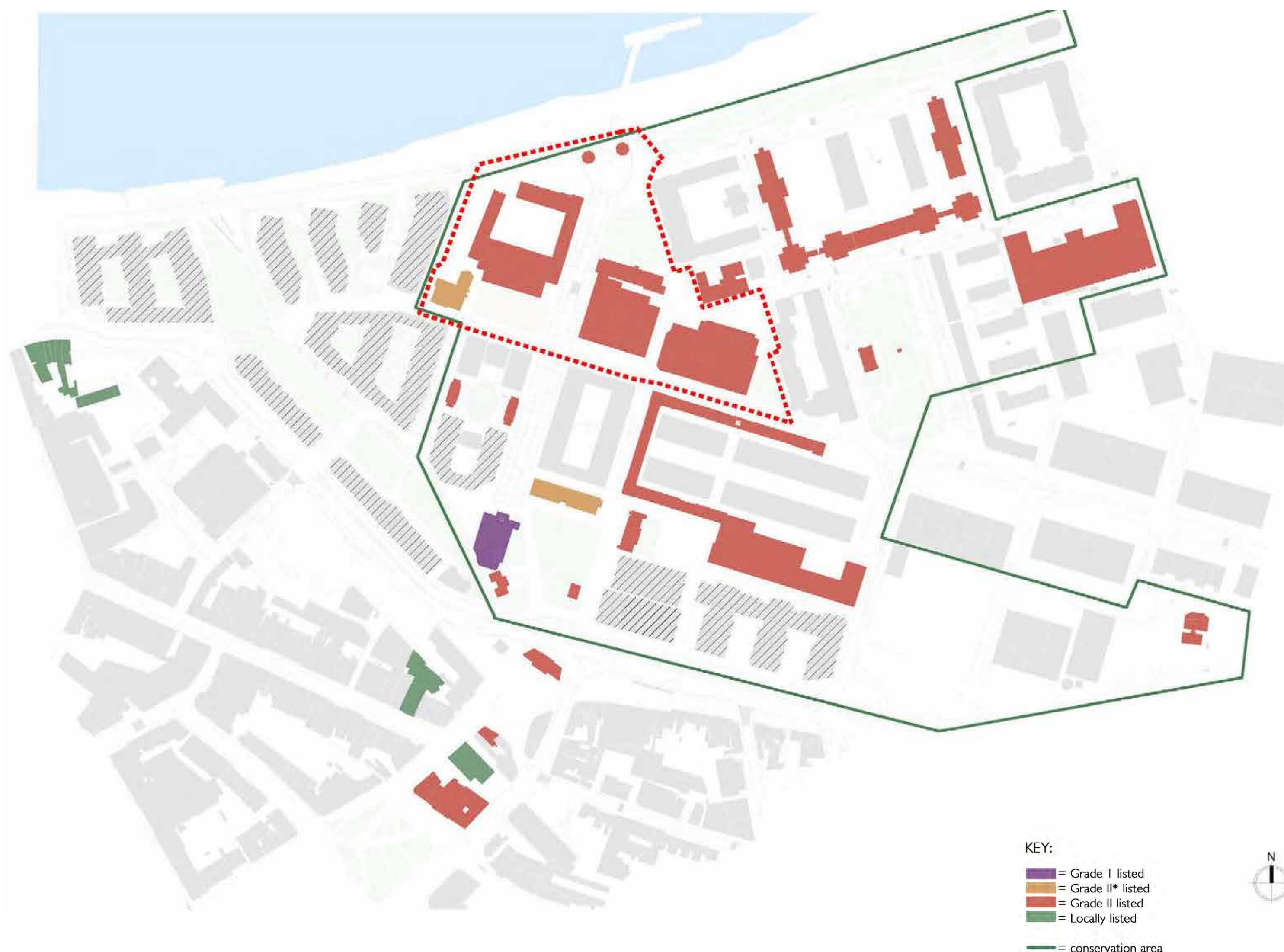

Conservation

There a number of listed and locally listed buildings set within the Royal Arsenal conservation area.

Woolwich Creative District Site Overview

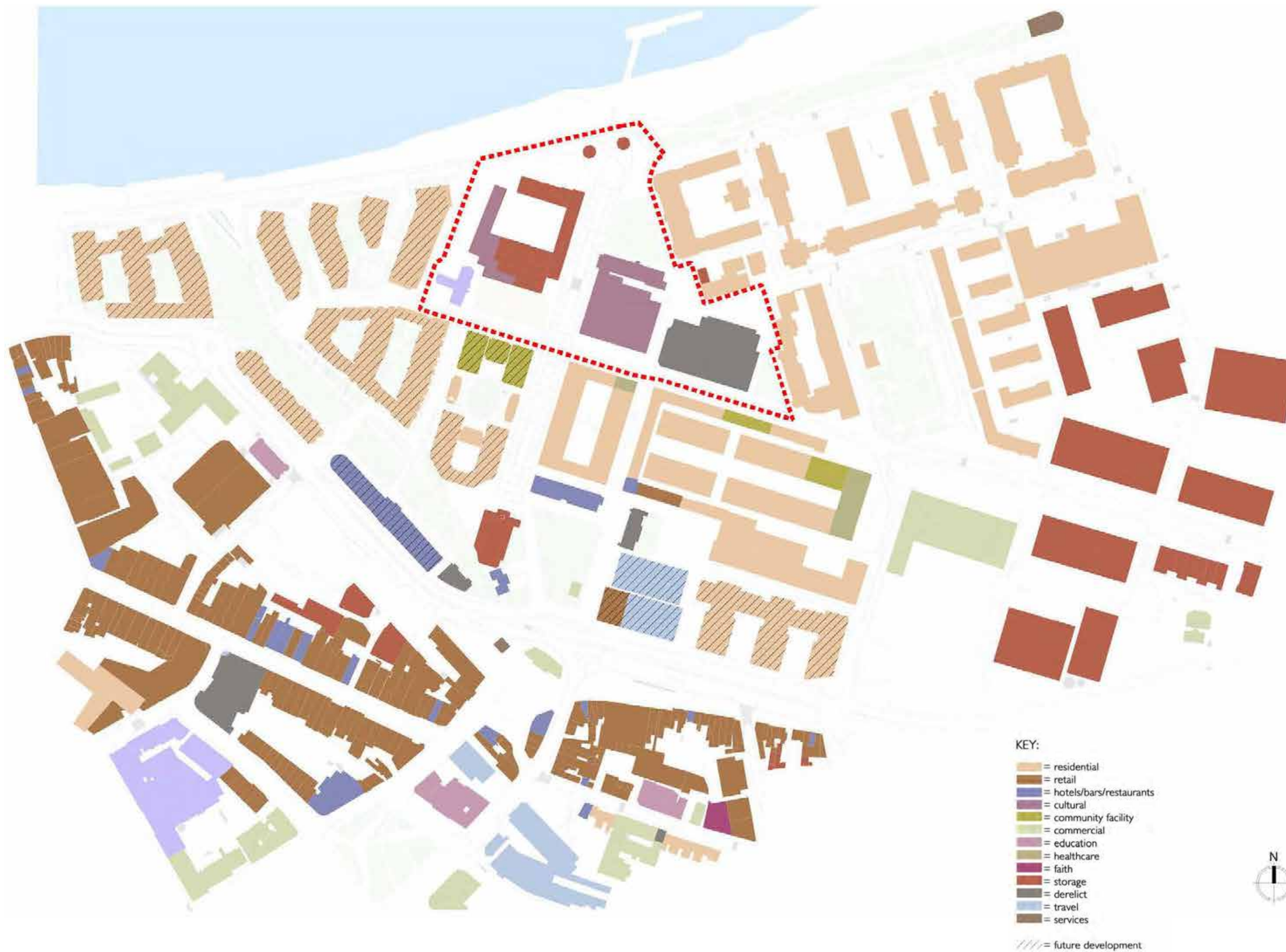

Landuse

Woolwich town centre is reasonably well equipped with the necessary day to day amenities.

There are numerous shopping streets south of the site, on the other side of Plumstead Road, however immediately surrounding the Royal Arsenal site, the land use is predominately residential.

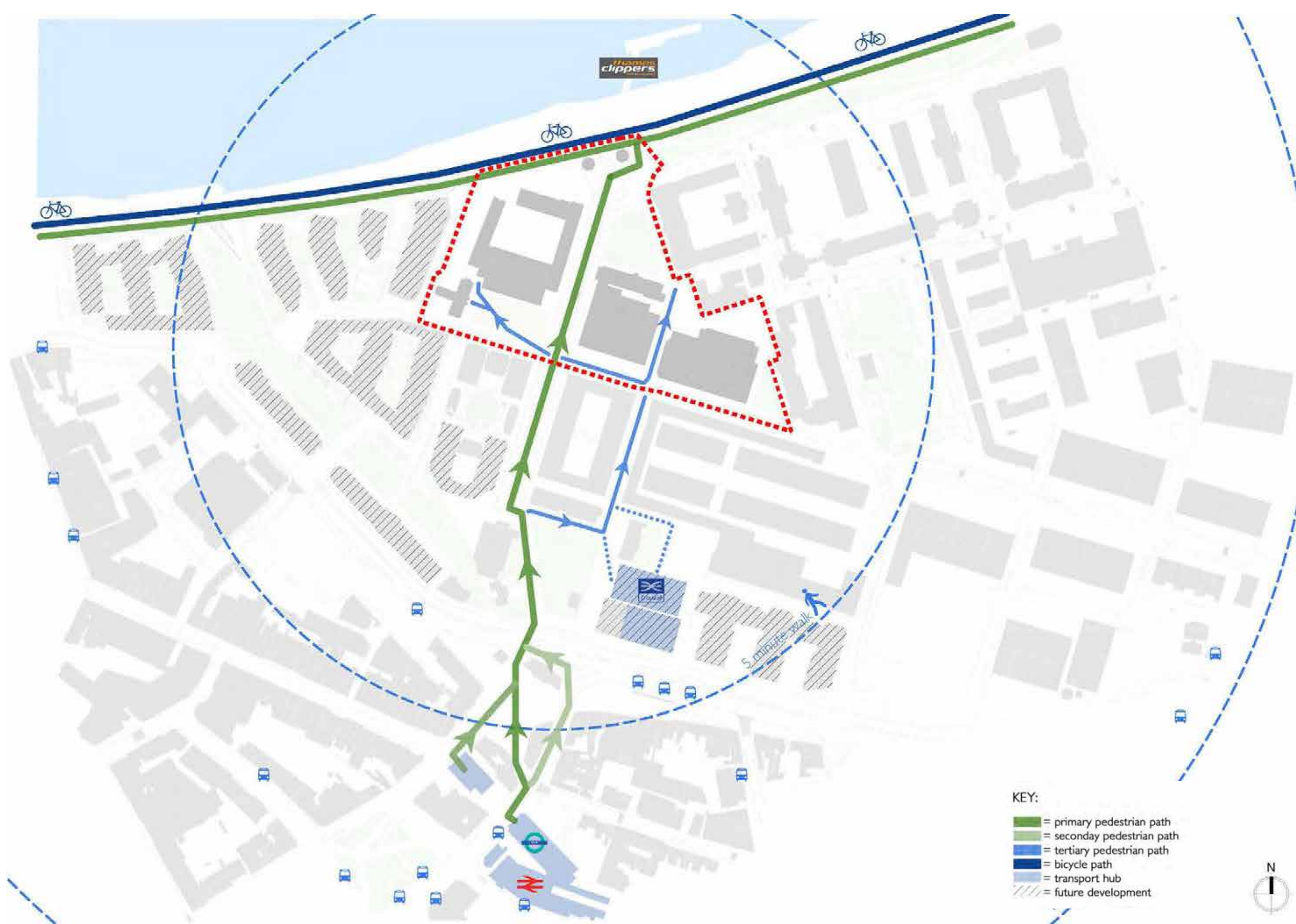

Public transport/cycling/walking

Transport links are good. There is a train station and a DLR station within 10 minutes walk of the site, as well as many bus routes. The Thames Clipper allows access directly to the site via boat, and there is a national bicycle path along the river edge.

The introduction of a new Crossrail hub in 2018 will dramatically improve access to and from Woolwich, with anticipated journey times of 8 minutes to Canary Wharf and 22 minutes to Bond Street. City Airport is currently accessible within 8 minutes via the DLR and with Crossrail, Heathrow will be approximately 50 minutes away.

Woolwich Creative District

Site Plan

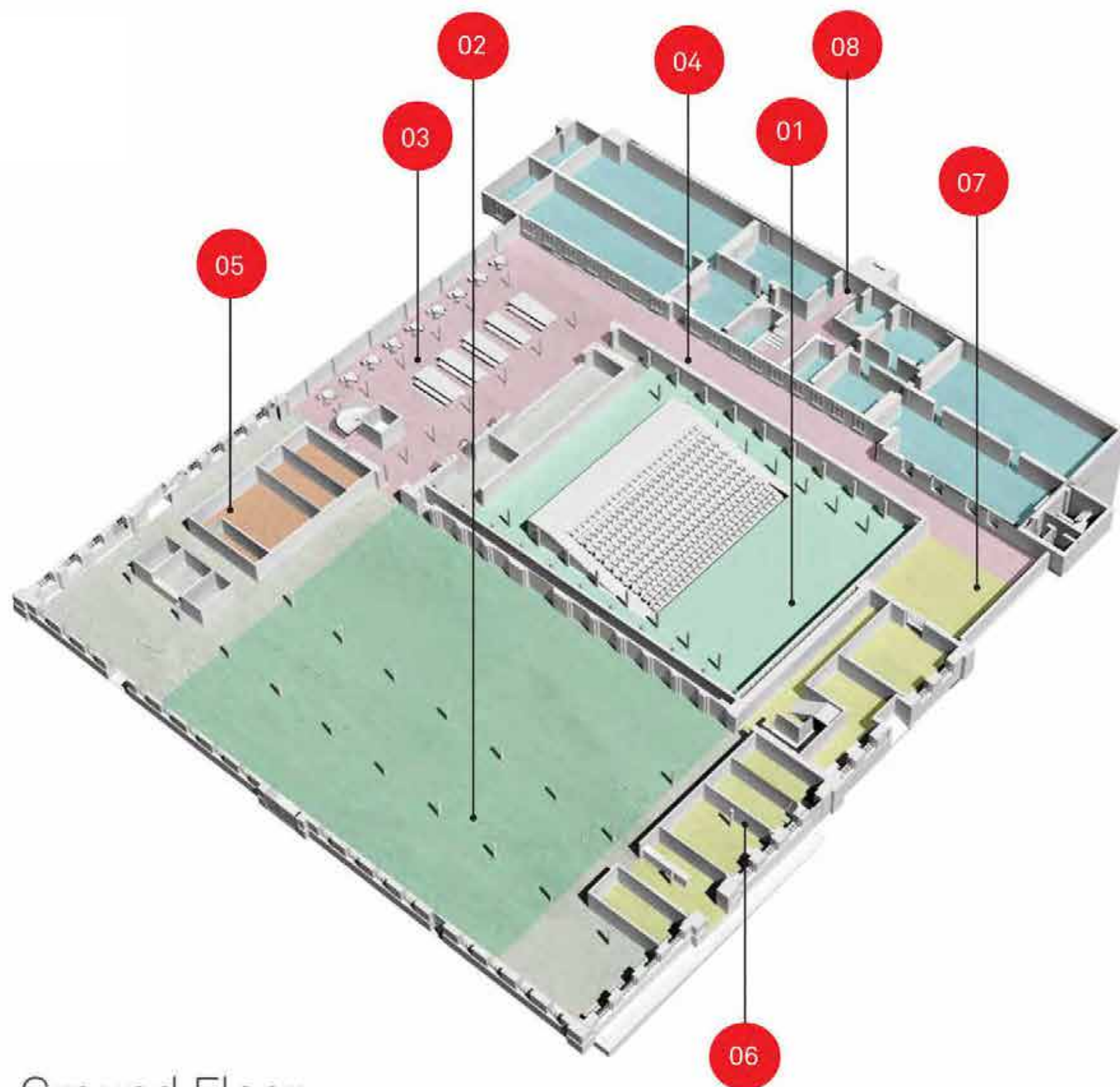

- 01. Auditorium / stage area
- 02. Performance / rehearsal space
- 03. Theatre foyer
- 04. Street
- 05. Front of house ancillary spaces
- 06. Back of house support / tech spaces
- 07. Get-In
- 08. Greenwich Heritage Centre

Ground Floor

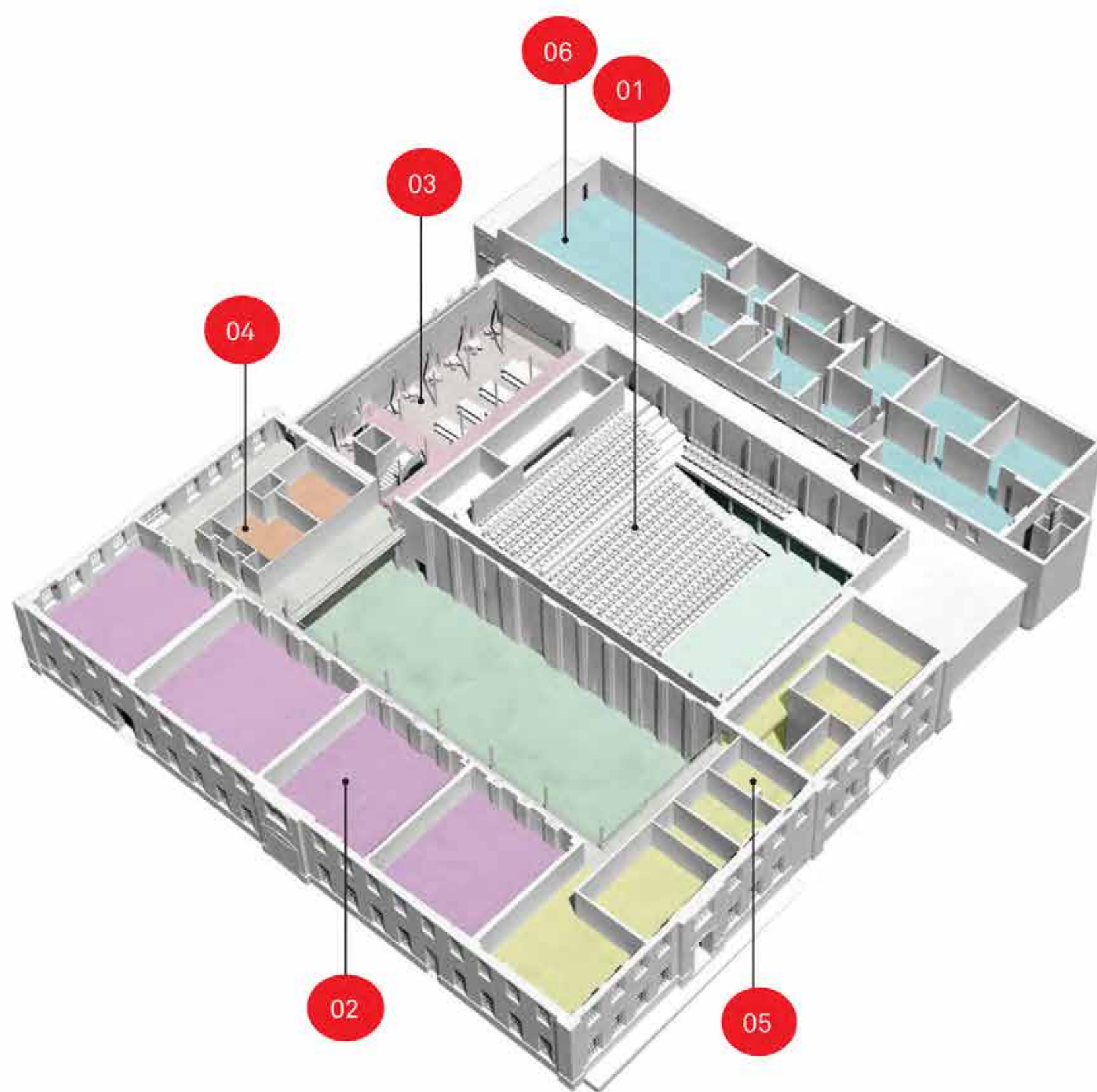

- 01. Auditorium / balcony
- 02. Studios
- 03. Theatre foyer
- 04. Studio ancillary spaces
- 05. Back of house support / tech spaces
- 06. Greenwich Heritage Centre

First Floor



Building 17

The Cartridge Factory

- Built 1855, Paper Cartridge Factory – constructed in response to the pressures placed on it by the Crimean War
- Designed initially to accommodate the specialised procedure for making seamless paper cartridges
- By 1857 it was producing 400,000 cartridges a day
- Lightweight, iron framed roof designed to allow explosions to be directed vertically and minimise damage
- In 1864 the upper storey was used for percussion cap making – a development in hand-gun ammunition and by 1866 the entire building was given over to this.
- During the First World War, under the leadership of Lilian Barker, female workers were employed in B17 which became a RAF bomb shop
- During the Second World War it became an electroplating factory for small gun barrels and at this time gantry cranes were added and parts of the iron frame removed



Building 18

Royal Laboratories Offices

- Built 1855 at the same time as B17 to provide offices for the Royal Laboratory Department
- Extended to the west in 1888 and to the east in 1920



Woolwich Creative District

Site Plan

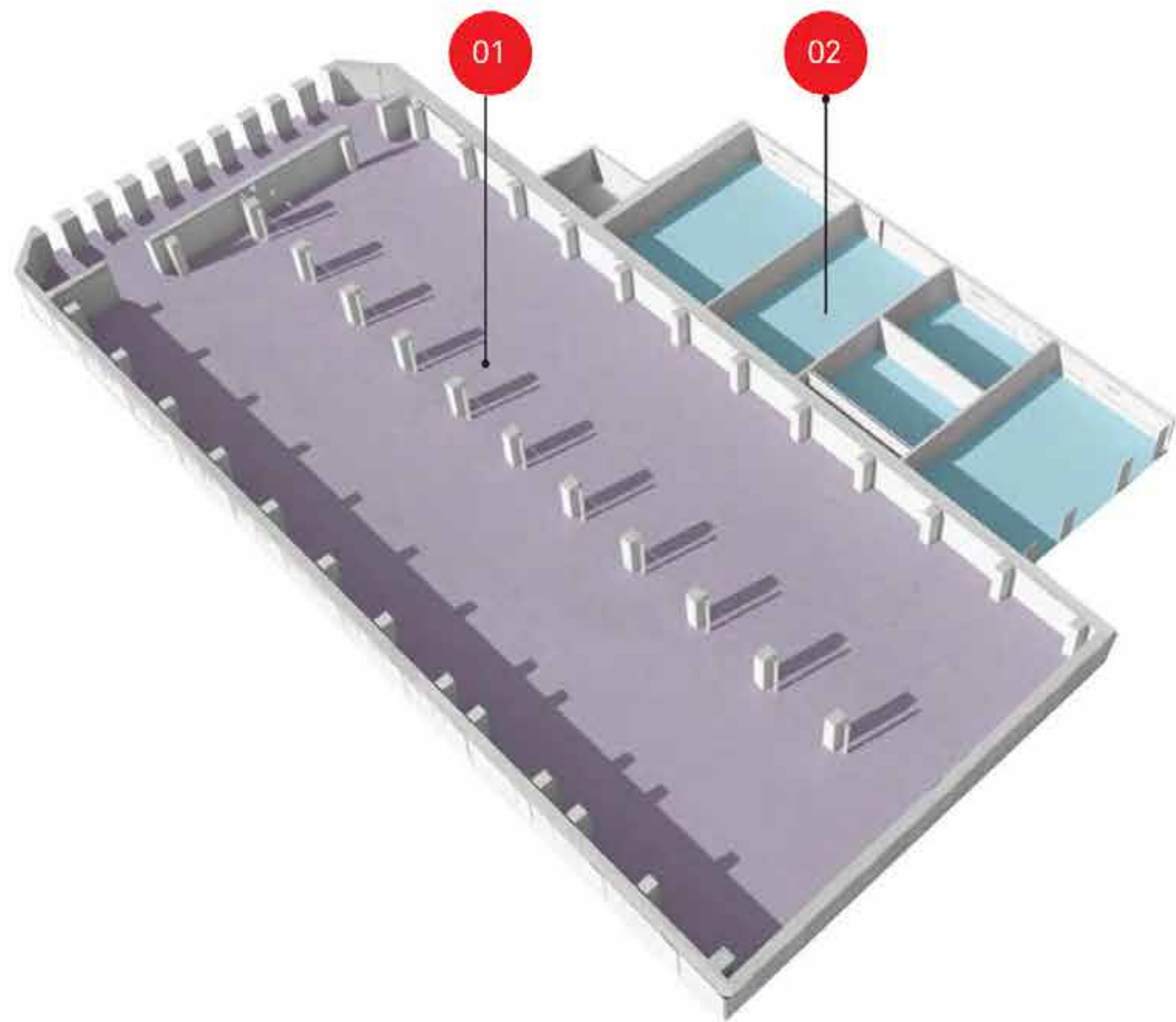

- 01. Multipurpose tenanted spaces
- 02. Offices / ancillary accommodation

Ground Floor

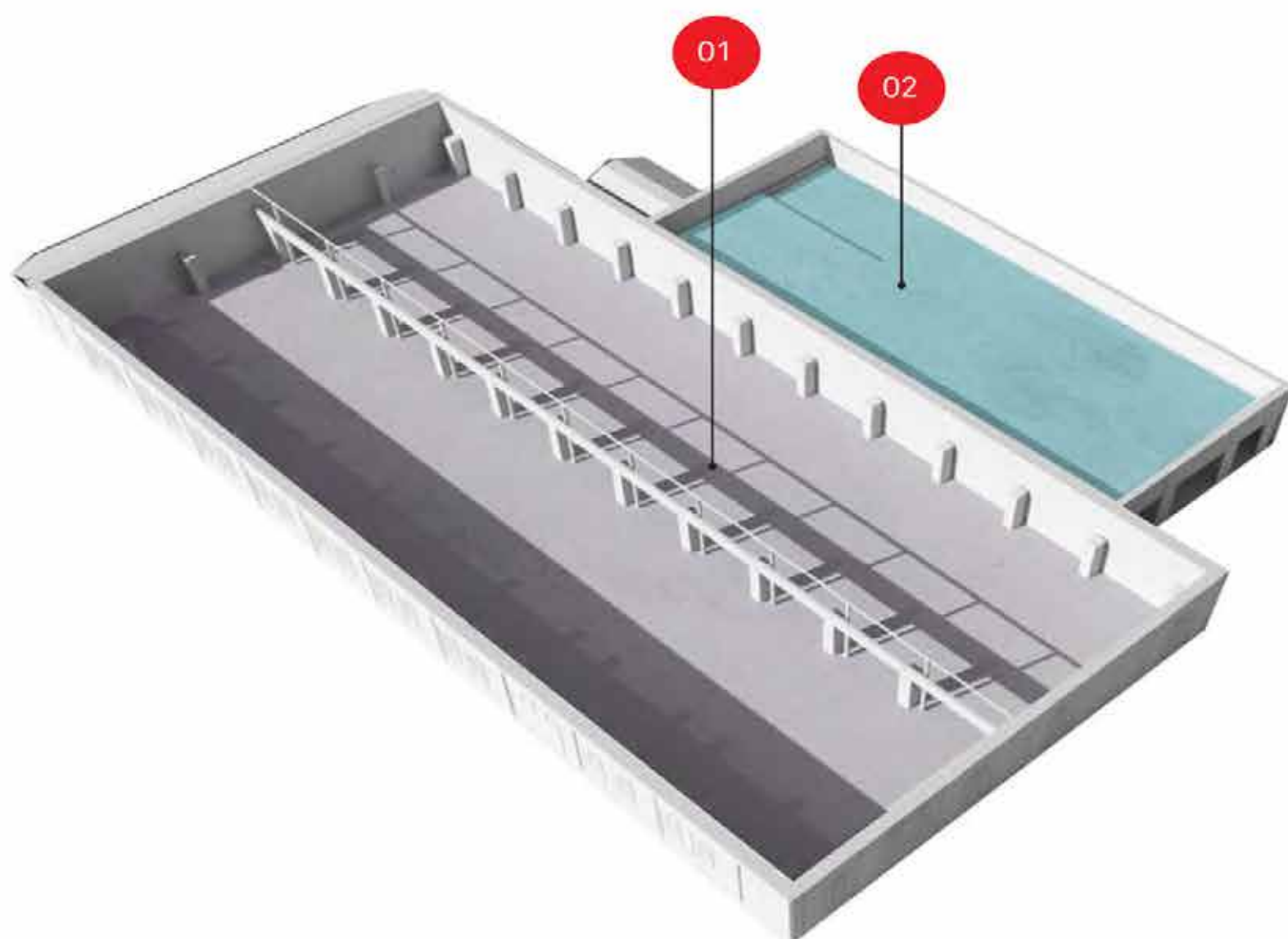

- 01. Void / temporary mezzanine level (Retrofit by tenant)
- 02. Offices / ancillary accommodation

— First Floor



Building 19

The Gun Carriage Shop

- Built in early 1860s and formed part of the Royal Carriage Department responsible of the design and manufacture of the wooden carriages for moving guns and cannons.
- Used to mount gun barrels onto the finished carriages.
- Designed to work in tandem with B10, The Royal Carriage Factory and connected by rail tracks

Woolwich Creative District

Site Plan



-1

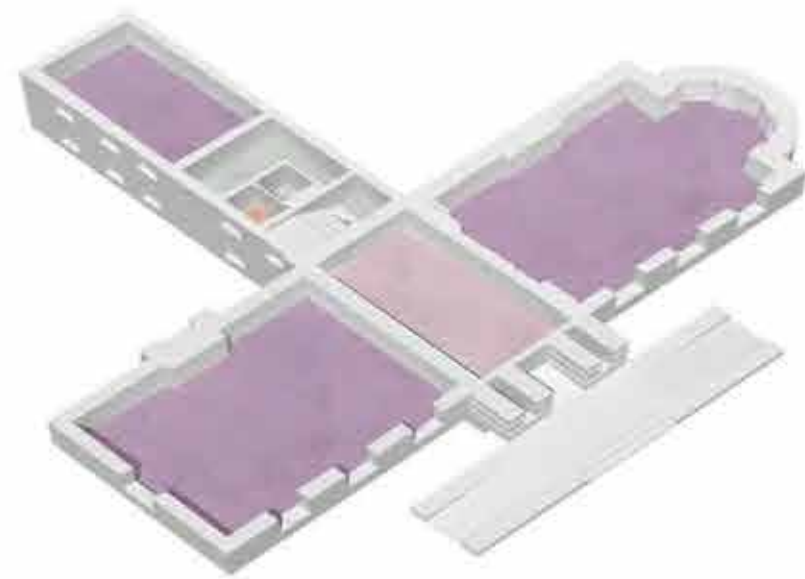

00

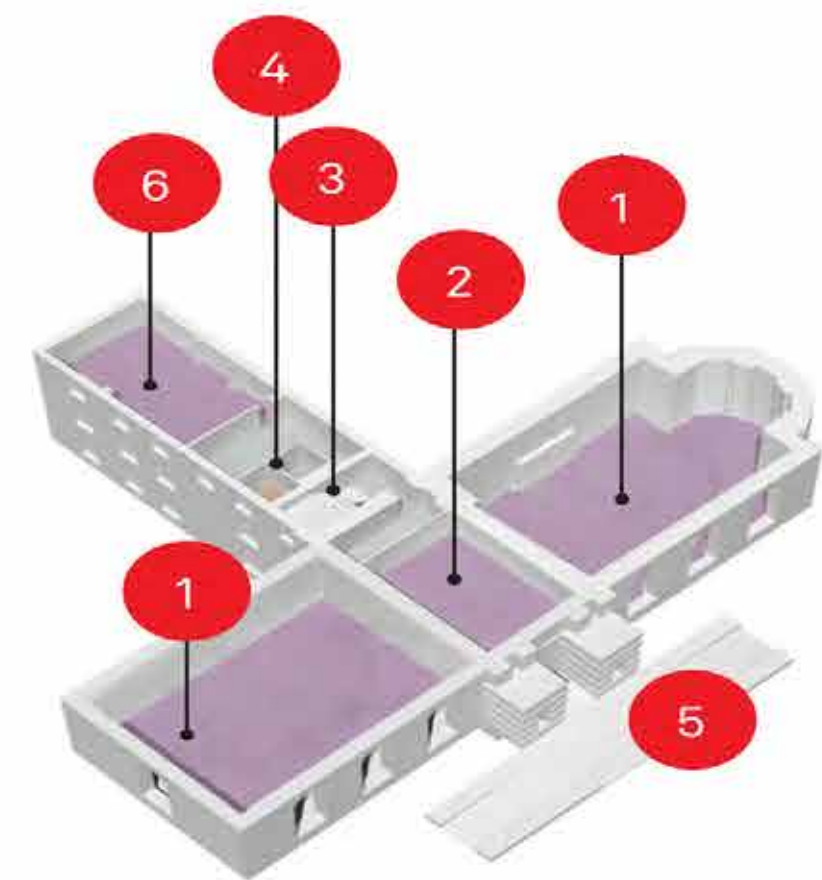

01

First Floor



02



03

- 01. Studio
- 02. Entrance lobby with rehearsal space over
- 03. Central Stair
- 04. New lift core
- 05. New ramped access
- 06. Office



Building 40

The Royal Military Academy

Built in phases from 1718 with the final wing to the south built in 1723. Built as a Board Room for Officers of the Ordnance – the governing body of the Royal Arsenal – and as an Academy Room for training cadets

Woolwich Creative District

Site Plan

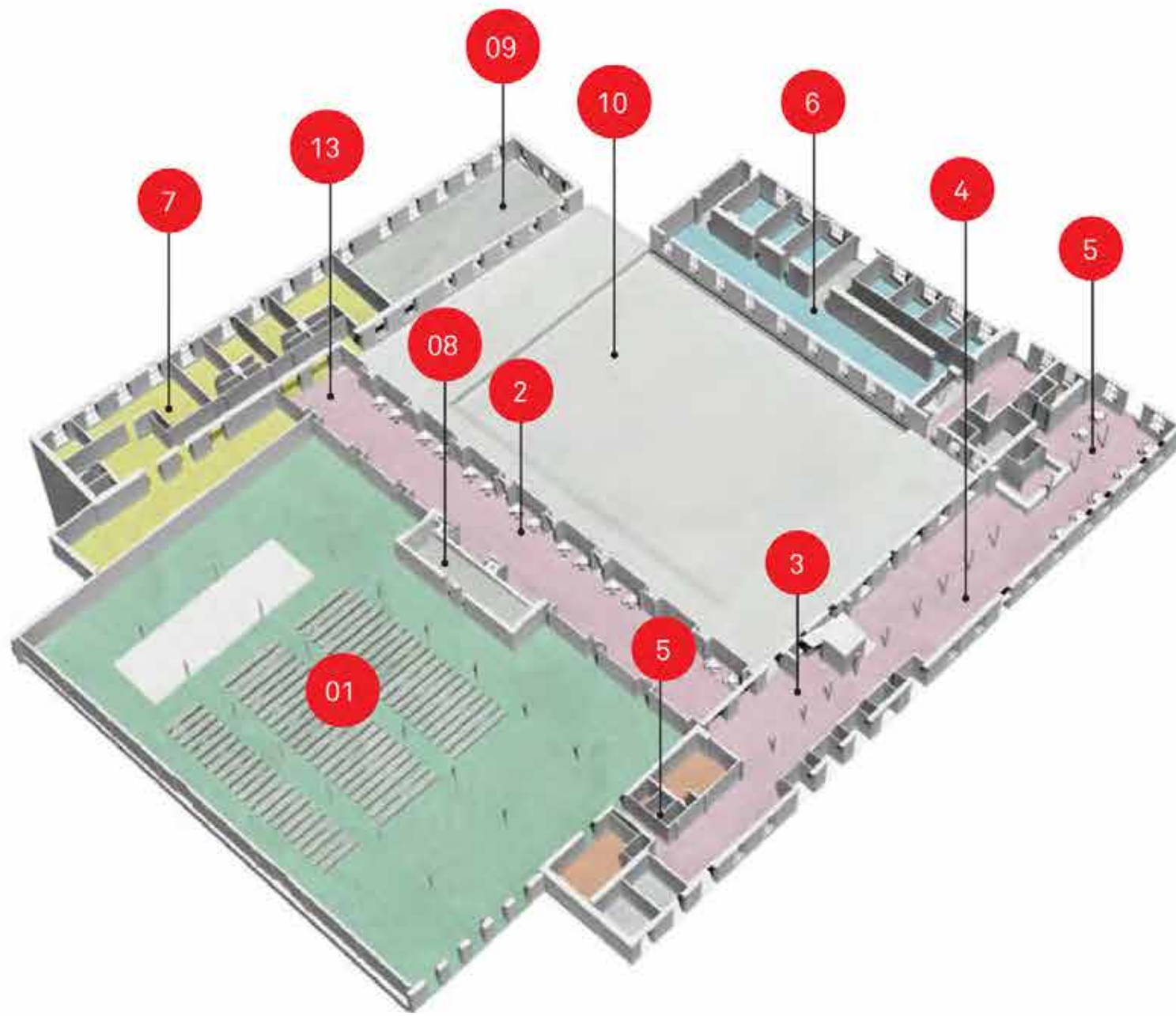

- 01. Performance space

- 02. Milling foyer

- 03. Main foyer

- 04. Making Woolwich Gallery

- 05. Green room

- 06. Artists Studio , Craft Workshop

- 07. Performance space back of house

- 08. Retained brick foyer

- 09. Greenwich archive (retained)

- 10. External courtyard

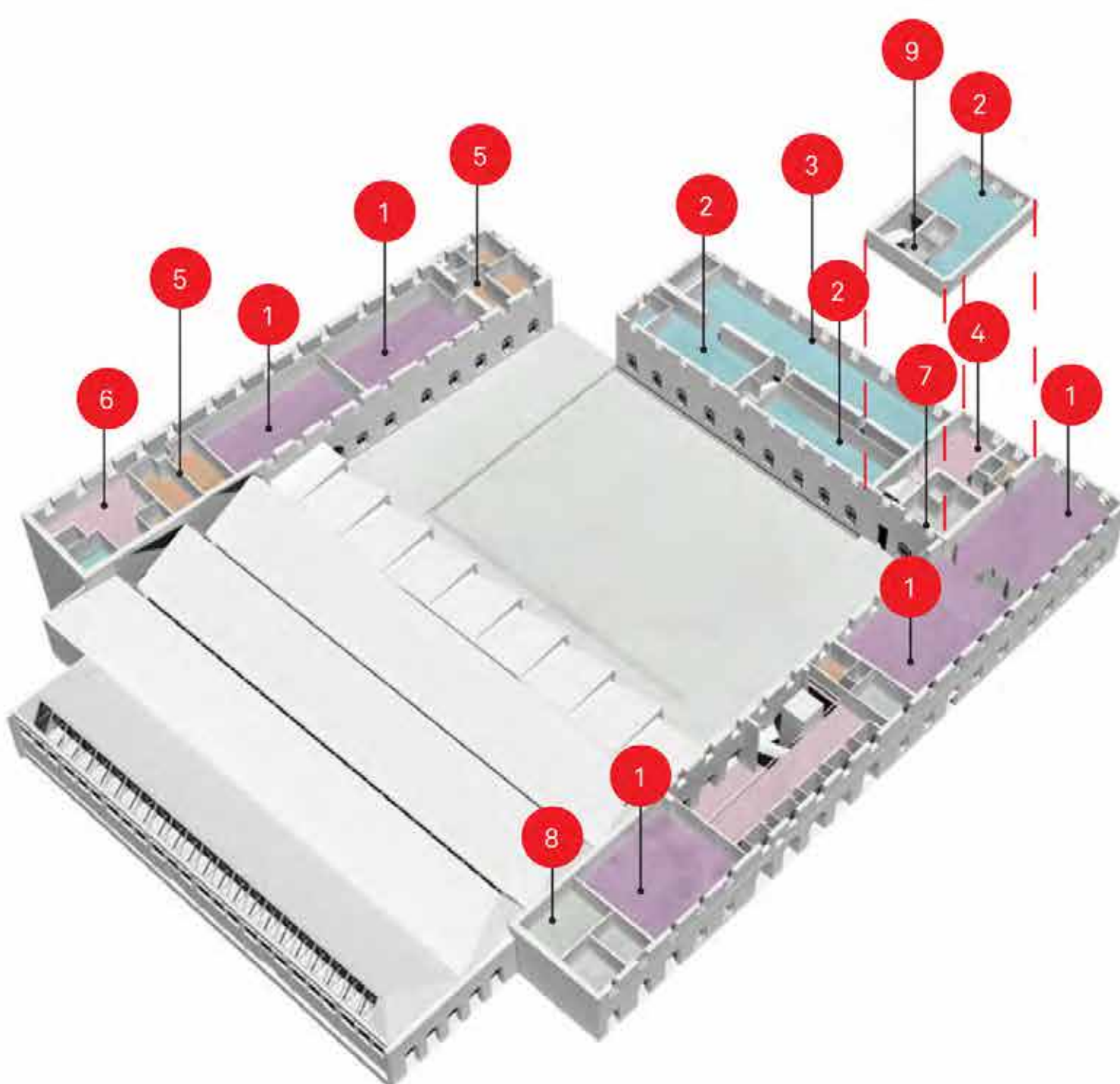

- 01. Studio space

- 02. Offices

- 03. Events space

- 04. Milling area

- 05. Back of house ancillary space (WC / shower)

- 06. Back of house offices

- 07. Ancillary space (WC / shower)

- 08. Machine / amp / dimmer room

- 09. New Stair / lift

First Floor



Building 41

The Ammunition Factory

- Built in phases from 1718 with the final wing to the south built in 1723. Built as a Board Room for Officers of the Ordnance – the governing body of the Royal Arsenal – and as an Academy Room for training cadets