

Welcome

Hello and welcome to this drop-in session for Trinity Park (formerly Morris Walk).

We are holding a number of different consultation events, that will help us to understand your views on your neighbourhood.

We are about to start the regeneration of Trinity Park.
Today's event is about:



Welcome



What is happening in the short term



How is it going to affect residents



How can the area be improved



How you can have Your Say

Join the conversation



FACTS:

- **The partnership:** Lovell, PA Housing Association and The Royal Borough of Greenwich are working in partnership to deliver Trinity Park
- **What the partnership does:** The regeneration of 3 estates Connaught, Morris Walk and Maryon Road & Grove Estates
- **What we've done to date:** delivering Trinity Walk (formerly Connaught Estate)
- The whole Trinity Scheme will provide approximately 1500 new homes.

CONTACT US

For more information, please contact:

Woolwich Estates Team
020 8921 6139
Woolwich.Estates@royalgreenwich.gov.uk

Alexandra Robins
Alexandra.Robins@lovell.co.uk

What has been achieved

PROJECT: TRINITY WALK, WOOLWICH

- The Royal Borough of Greenwich appointed Lovell in July 2013 as its development partner for the Woolwich regeneration programme, starting with Trinity Walk.
- Lovell's vision is to create a high-quality development with a strong sense of place, where people choose to live.



AT A GLANCE

- Trinity Walk is transforming the area into a vibrant mixed community of varied homes for all
- A variety of apartments and townhouses for people at all stages of life
- Help to buy properties
- First occupants moved-in two years before anticipated
- All homes are designed to sustainable standards

WORKING WITH THE COMMUNITY

- Working close with the Community to ensure a continuous engagement with the residents
- A variety of engagement methods including Site Visits, School/College workshops, Drop In sessions etc.
- Working close with local groups and key stakeholders
- Dedicated Employment and Skills Plans offering training opportunities, apprentices and working experience

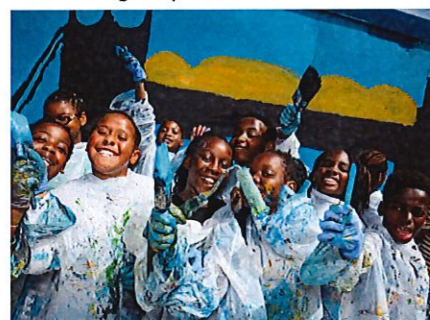

SOCIAL VALUE & KEY PROJECT FIGURES

TRINITY WALK MAJOR URBAN REGENERATION SCHEME IN WOOLWICH



APPROX. 1500
NEW MIXED
TENURE HOMES



90
apprenticeships and
equivalent of 177 years
of training for local
people over the life of
the scheme

£150,000
COMMUNITY
FUND CREATED

Creating jobs for
local workforce
in the area

APARTMENTS
98%
First Time Buyers
HOUSES
50% First Time
Buyers on the
houses in Phase 1

70%
new buyers came
from within a
3-mile radius

Labour from
within SE18 and
SE7 postcodes

Draft Hoarding Strategy for Trinity Park

The diagram on this board illustrates the changes around your neighbourhood when the hoarding will be completed. Please also see below some examples of hoarding.

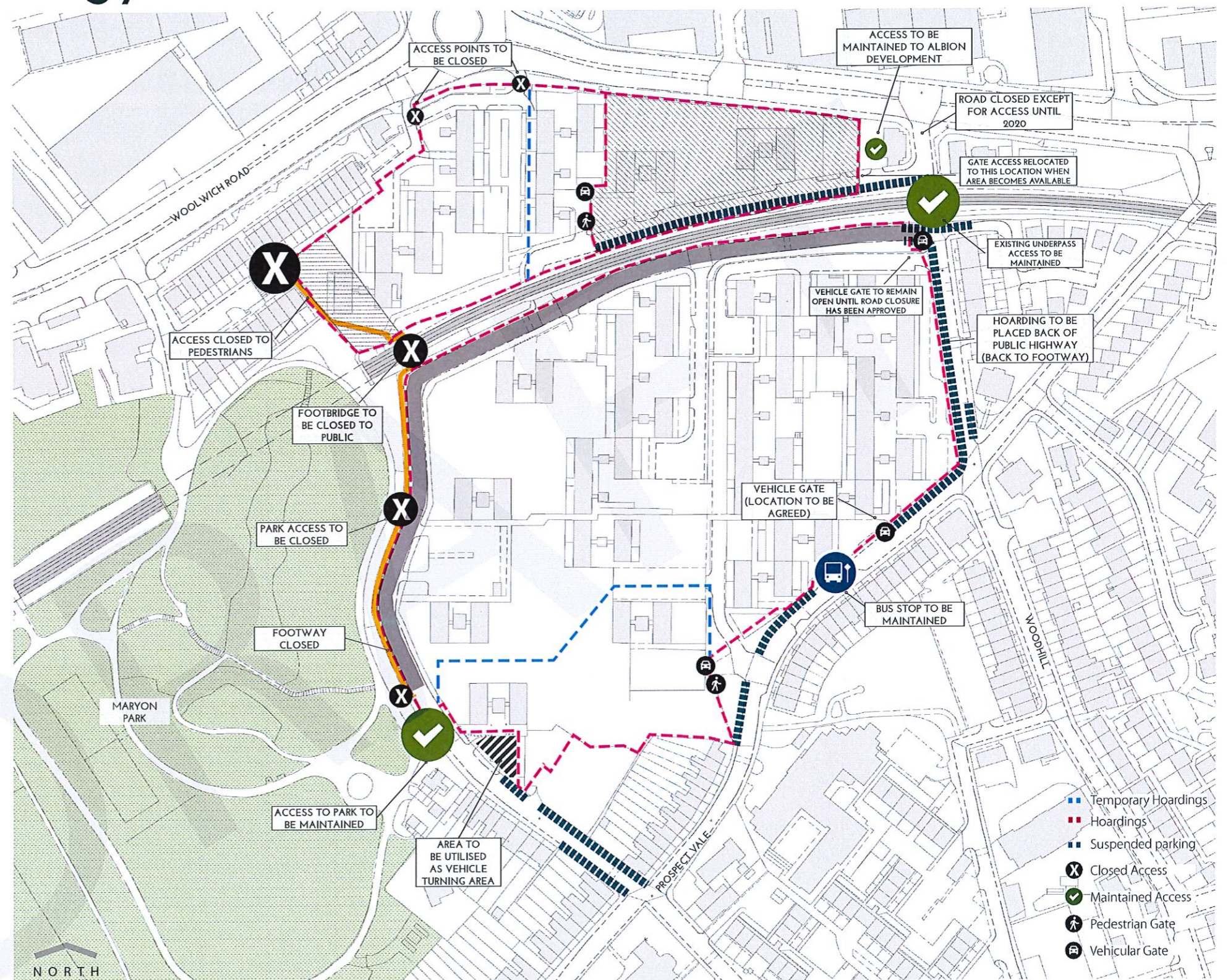
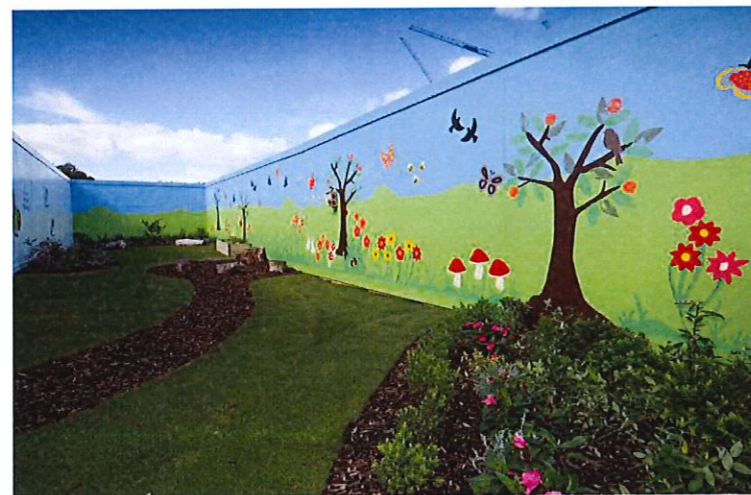

Demolition Plan

Demolition works on the Morris Walk Estate will be carried sympathetically and considerately to all surrounding residents. We shall strive to minimise inconvenience and regularly update residents of the progress through monthly progress newsletters.

We will adopt a number of measures in order to minimise the impact of the demolition process to the neighbourhood:

- Control of noise, dust and vibration
- Minimise the production of waste from development
- Safeguarding of ecological aspects of the site and the surrounding neighbourhoods
- No works outside agreed working hours
- Avoiding school pickup times
- Providing onsite personnel
- Provision of out of hours CCTV
- Location of site entrances, exits and haul roads away from sensitive locations
- Drop-in sessions and emergency numbers provided for residents
- Controlled number of construction vehicles
- Unnecessary vehicle movements will be avoided to minimise noise
- Keeping fencing, barriers, scaffolding and screening clean
- No burning of waste wood or other materials on site



Structures will be demolished via controlled removal of sections of each building, ensuring safety and minimising disruption

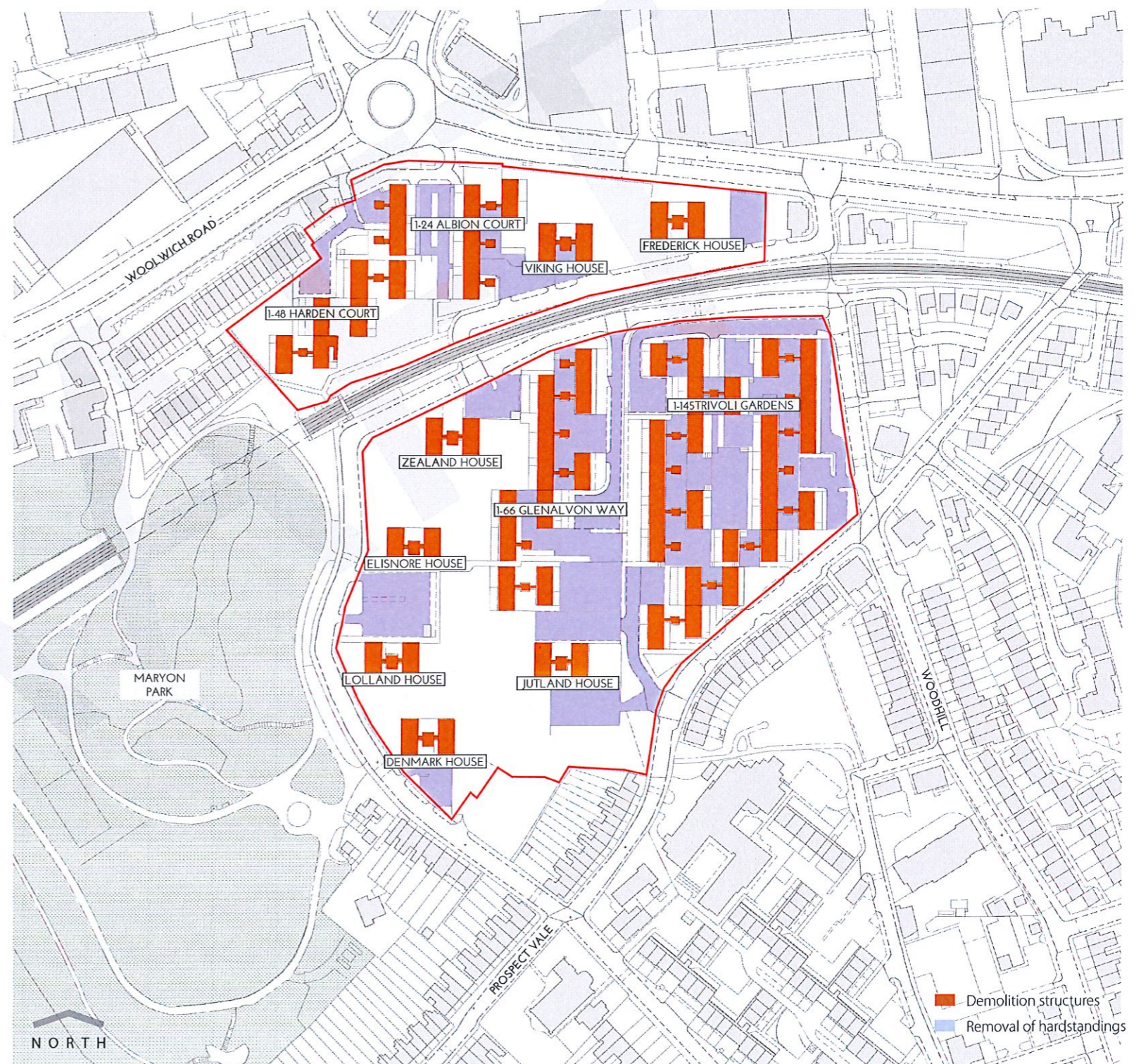

Vision for Local Area

We would like to know what you think about your neighbourhood, the local facilities and the open spaces. Please use the sticky notes and the questionnaire to share your views.

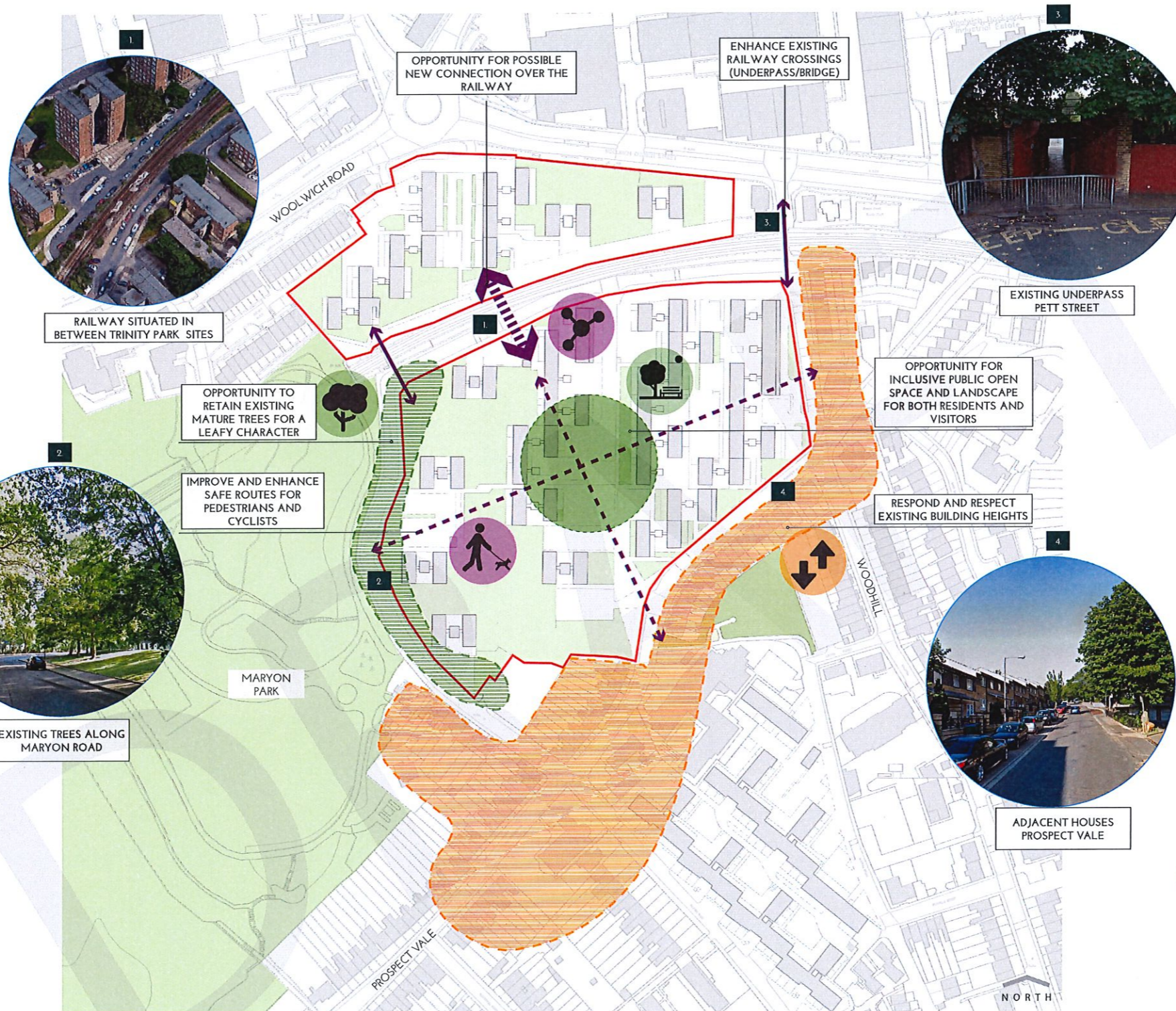

HAVE YOUR SAY
Is there anything you do not like about your neighbourhood?

HAVE YOUR SAY
What local groups do you attend?

HAVE YOUR SAY
What community, health & education facilities do you or your family use?

HAVE YOUR SAY
As we develop our detailed proposal, what would make the neighbourhood better?

HAVE YOUR SAY
What do you like about your neighbourhood?

The local area

Site and Local Context Photos

Trinity Park Neighbourhood



Draft Programme (October '19 - June '20)

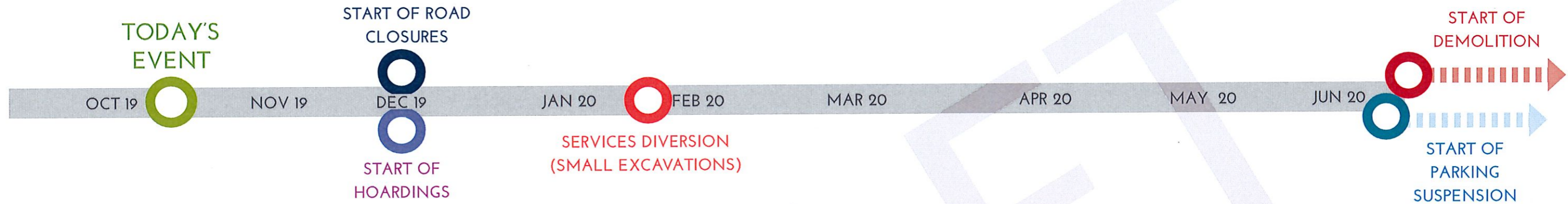

Engagement Programme & Events Timeline

